



Line array element, 2 way passive or active, with 12" LF and 3" voice coil / 1.4" throat HF.

The GEO M12 speaker is a powerful high-technology line array.

GEO M12 main features

- Powerful line array element that can be stacked or flown, with or without its companion sub the MSUB18.
- Integrated rigging hardware with no loose part and AutoRig™ feature.
- Available in Touring or Installation versions, with custom RAL colour options.
- Incorporates latest NEXO patented technology from the flagship STM series.
- Comprehensive range of versatile, multifunction accessories for deploying the GEO M12 in a wide variety of applications.

The GEO M12 shares the same aesthetic design and sonic signature as the other line array in the GEOM family, while offering an unprecedented level of flexibility in all size applications.

High-density package

The GEO M12 is 370mm x 700mm x 446mm (14.6" x 27.6" x 17.6") and weighs 34 kg (75 lbs). Using latest-generation Neodymium drivers, arrays of up to 12 boxes can be used in most venues, indoor or outdoor.

Advanced NEXO technology included

From speakers to waveguide, GEO M12 is packed with important NEXO technical innovations.

The HF uses our patented Hyperbolic Reflective Wavesource (HRW™) technology while the LF benefits from the patented Phase Directivity Device (PDD™).

The enclosure itself uses the same honeycomb structure and urethane co-polymer material as NEXO's flagship STM Series, while the bass port features an improved version of our patented V-shaped profile.

Precise matching directivity

The GEO M12 is available with two vertical dispersions; 10° for the GEO M1210 and 20° for the GEO M1220.

The horizontal directivity is 80° by default for both modules, but by adding an optional patented Configurable Directivity Device (CDD™) it can be changed in seconds to 120° through a magnetic fixing system.

And perfect coverage is achieved with a choice of 11 angles between boxes and our acclaimed simulation software: NS-1.

Installation and Touring versions

Further versatility is assured by the availability of two versions.

The Touring version uses a magnetically fixed front steel grill with a back mesh. The integrated AutoRig™ system automatically connects the front rigging system when speakers are assembled, with a guided back rigging system for easy angle adjustment. The connection plate uses NL4 connectors.

The Installation version keeps the same acoustic design but comes with a fixed front steel grid covered by an acoustic cloth. The rigging system uses safety nuts and the connectivity is made through cable gland and captive four core cables, this version being then IP54 rated.

Both versions are available in black, white or custom RAL colour on request.

Perfect phase alignment

The GEO M12 shares the same phase response than other NEXO speakers, making it extremely easy to mix with other NEXO systems, e.g for side fill or front fill, or when used with any NEXO subs, without risk of comb filtering or requiring complex electronic adjustment.



On the back side of the GEO M12 module, a protected switch allow to change on the fly from 2 way passive to 2 way active mode.



NEXO is one of the world's leading sound reinforcement loudspeaker manufacturers. Founded in 1979, the company is dedicated to crafting practical solutions with solid engineering. Each new design begins with a proprietary sophisticated computer simulation process that allows every parameter to be extensively modeled and simulated, leading to breakthrough cost and performance gains. NEXO's comprehensive product line includes loudspeakers, analogue and digital control electronics and amplification; all designed to deliver consistent sound quality and long term reliability for a broad range of applications.

NEXO S.A.
 Parc d'Activité
 du Pré de la Dame Jeanne
 B.P. 5
 60128 PLAILLY
 Tel: +33 (0) 3 44 99 00 70
 Fax: +33 (0) 3 44 99 00 30
 e-mail: info@nexo.fr

	GEO M1210 (without CDD™)	GEO M1210 (with CDD™)	GEO M1220 (without CDD™)	GEO M1220 (with CDD™)
GEO M12 WITH NEXO PROCESSING				
Frequency Response @-6 dB	50 Hz to 20 kHz			
Sensitivity 1W@1m	105 dB SPL Nominal			
Peak SPL@1m	140 dB			
Vertical Dispersion	10°		20°	
Horizontal Dispersion	80°	120°	80°	120°
Passive Mode Crossover Frequency	1.1 kHz			
Nominal Impedance	Active mode: (8 Ω LF + 16 Ω HF) / Passive mode: 8 Ω			
Recommended Power	Active mode: (1250 Watts LF + 625 W HF) / Passive mode: 1250 Watts			
PRODUCT FEATURES				
LF Component	1 x 12" 8 Ohms long excursion Neodymium driver with PDD™			
HF Component	1 x 3" voice coil 1.4" throat driver on a BEA/FEA optimized HR Wavesource™			
Height x Width x Depth	370mm x 700mm x 446 mm (14.6" x 27.6" x 17.6")			
Weight: Net	34 kg (75 lbs)			
Connectors (Touring version)	2 x NL4, 4 poles connectors			
Touring Connectors pinout	Active mode: (1+/1- LF, 2+/2- HF) / Passive Mode: (1+/1- Through, 2+/2- GEO M12)			
Connectors (Install version)	2 x Cable gland with 4 cores cables			
Active / Passive mode selection	Ruggedized, recessed, waterproof 2 position switch			
Construction	Lightweight Polyurethane Composite			
Fittings	2 x Side handles horizontal + back grip			
Front Finish (Touring version)	Steel front grill + back mesh			
Front Finish (Install version)	Acoustic fabric fitted front grill			
SYSTEM OPERATION				
Operating temperature range	0°C - 40 °C (32° F - 104° F)			
Storage temperature range	-20 °C - 60 °C (-4 ° F - 140° F)			
Recommended powering solution	NXAMP4x4 Powered TDcontroller: 3 x GEO M12 per channel			
Optional powering solution	NXAMP4x2mk2 Powered TDcontroller: 1 x GEO M12 per channel NXAMP4x1mk2 Powered TDcontroller (Bridged): up to 2 x GEOM12 per channel			

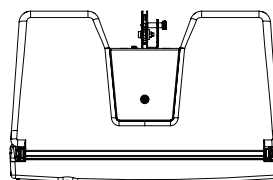
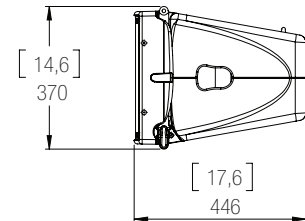
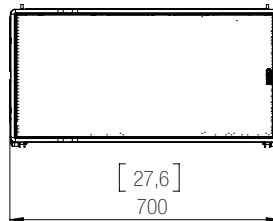

LIMITED WARRANTY

NEXO loudspeakers and electronics are covered against defects in workmanship or materials for a period of five (5) years from the original date of purchase. At the option of NEXO the defective item will be repaired/replaced with no charge for materials/labour. The item is to be adequately packaged and dispatched, pre-paid, to a NEXO authorised distributor/service centre. Unauthorised repair shall void the warranty. The NEXO warranty does not cover cosmetics or finish and does not apply to any items which in NEXO's opinion have failed due to used abuse, accidents, modifications or any type of misuse. All images and text herein are the property of NEXO SA, and deemed accurate, although specifications are subject to change without notice.