

USER'S MANUAL
BEDIENUNGSANLEITUNG
MANUEL D'UTILISATION
MANUAL DE USUARIO
INSTRUKCJA OBSŁUGI
MANUALE D'USO



V1.10

F2 D IP

DAYLIGHT LED FRESNEL SPOT LIGHT IP65
CLF2DIP

F2 T IP

TUNGSTEN LED FRESNEL SPOT LIGHT IP65
CLF2TIP

CONTENTS / INHALTSVERZEICHNIS / CONTENU / CONTENIDO / TREŚĆ / CONTENUTO

ENGLISH

INFORMATION ON THIS USER MANUAL	6
INTENDED USE	6
DEFINITIONS AND SYMBOL EXPLANATIONS	6
SAFETY INSTRUCTIONS	7
NOTES ON PORTABLE OUTDOOR DEVICES	10
PACKAGING CONTENT	10
INTRODUCTION	11
CONNECTIONS, OPERATING AND DISPLAY ELEMENTS	12
OPERATION	14
SETUP AND INSTALLATION	19
ASSEMBLE / DISASSEMBLE SASH LIMITER AND FILTER FRAME / CLEAN LENSES	20
CARE, MAINTENANCE AND REPAIR	22
DIMENSIONS	23
TECHNICAL DATA	24
EXPLANATION OF IP PROTECTION CLASS	26
MINIMUM DISTANCE TO ILLUMINATED SURFACE	26
MINIMUM DISTANCE TO NORMALLY FLAMMABLE MATERIALS	26
DISPOSAL	27
MANUFACTURER'S DECLARATIONS	

DEUTSCH

INFORMATIONEN ZU DIESER BEDIENUNGSANLEITUNG	29
BESTIMMUNGSGEMÄSSER GEBRAUCH	29
BEGRIFFS- UND SYMBOLERKLÄRUNGEN	29
SICHERHEITSHINWEISE	30
HINWEISE FÜR ORTSVERÄNDERLICHE OUTDOOR-GERÄTE	33
LIEFERUMFANG	33
EINFÜHRUNG	34
ANSCHLÜSSE, BEDIEN- UND ANZEIGEELEMENTE	35
BEDIENUNG	37
AUFSTELLUNG UND MONTAGE	42
FLÜGELBEGRENZER UND FILTERRAHMEN MONTIEREN / DEMONTIEREN / LINSEN REINIGEN	43
PFLEGE, WARTUNG UND REPARATUR	44
ABMESSUNGEN	46
TECHNISCHE DATEN	47
ERLÄUTERUNGEN ZUR IP-SCHUTZART	49
MINDESTABSTAND ZUR BELEUCHTETEN FLÄCHE	49

MINDESTABSTAND ZU NORMAL ENTFLAMMBAREN MATERIALIEN	49
ENTSORGUNG	50
HERSTELLERERKLÄRUNGEN	

FRANÇAIS

INFORMATIONS CONCERNANT CE MANUEL D'UTILISATION	52
UTILISATION CONFORME	52
EXPLICATIONS DES TERMES ET DES SYMBOLES	52
CONSIGNES DE SÉCURITÉ	53
REMARQUES CONCERNANT LES APPAREILS D'EXTÉRIEUR MOBILES	56
CONTENU DE LA LIVRAISON	56
INTRODUCTION	57
RACCORDEMENTS, ÉLÉMENTS DE COMMANDE ET D'AFFICHAGE	58
UTILISATION	60
INSTALLATION ET MONTAGE	65
MONTAGE/DÉMONTAGE DES VOLETS COUPE-FLUX ET DU CADRE POUR FILTRE / NETTOYAGE DES LENTILLES	66
ENTRETIEN, MAINTENANCE ET RÉPARATION	67
DIMENSIONS	69
CARACTÉRISTIQUES TECHNIQUES	70
EXPLICATIONS RELATIVES À L'INDICE DE PROTECTION IP	72
DISTANCE MINIMALE PAR RAPPORT À LA SURFACE ÉCLAIRÉE	72
DISTANCE MINIMALE PAR RAPPORT AUX MATÉRIAUX NORMALEMENT INFLAMMABLES	72
MISE AU REBUT	73
DÉCLARATIONS DU FABRICANT	

ESPAÑOL

INFORMACIÓN SOBRE ESTE MANUAL DE INSTRUCCIONES	75
USO PREVISTO	75
TÉRMINOS Y SÍMBOLOS	75
INSTRUCCIONES DE SEGURIDAD	76
INDICACIONES PARA EQUIPOS PORTÁTILES DE EXTERIOR	79
VOLUMEN DE SUMINISTRO	79
INTRODUCCIÓN	80
CONEXIONES, ELEMENTOS DE MANEJO Y ELEMENTOS DE VISUALIZACIÓN	81
MANEJO	83
INSTALACIÓN Y MONTAJE	88
MONTAR / DESMONTAR EL LIMITADOR DE FAJA Y EL MARCO DEL	

FILTRO / LIMPIAR LAS LENTES	89
CUIDADO, MANTENIMIENTO Y REPARACIÓN	90
MEDIDAS	92
DATOS TÉCNICOS	93
EXPLICACIÓN SOBRE LA CLASE DE PROTECCIÓN IP	95
DISTANCIA MÍNIMA CON RESPECTO A LA SUPERFICIE ILUMINADA	95
DISTANCIA MÍNIMA CON RESPECTO A MATERIALES NORMALMENTE INFLAMABLES	95
ELIMINACIÓN	96
DECLARACIONES DEL FABRICANTE	

POLSKI

INFORMACJE DOTYCZĄCE NINIEJSZEJ INSTRUKCJI OBSŁUGI	98
UŻYTKOWANIE ZGODNE Z PRZEZNACZENIEM	98
OBJAŚNIENIA TERMINOLOGII I SYMBOLI	98
ZASADY BEZPIECZEŃSTWA	99
UWAGI DOTYCZĄCE PRZENOŚNEGO SPRZĘTU ZEWNĘTRZNEGO	102
ZAKRES DOSTAWY	102
WPROWADZENIE	103
PRZYŁĄCZA, ELEMENTY OBSŁUGI I WSKAŹNIKI	104
OBSŁUGA	106
USTAWIANIE I MONTAŻ	111
MONTAŻ / DEMONTAŻ OGRANICZNIKA SKRZYDEŁKOWEGO I RAMY FILTRA / CZYSZCZENIE SOCZEWEK	112
CZYSZCZENIE, KONSERWACJA I NAPRAWY	113
WYMIARY	115
DANE TECHNICZNE	116
OBJAŚNIENIA DOTYCZĄCE STOPNIA OCHRONY IP	118
MINIMALNA ODLEGŁOŚĆ OD POWIERZCHNI OŚWIETLANEJ	118
MINIMALNA ODLEGŁOŚĆ OD NORMALNIE ŁATWOPALNYCH MATERIAŁÓW	118
UTYLIZACJA	119
OŚWIADCZENIA PRODUCENTA	

ITALIANO

INFORMAZIONI SUL PRESENTE MANUALE D'USO	121
UTILIZZO CONFORME	121
SPIEGAZIONE DI CONCETTI E SIMBOLI	121
INDICAZIONI SULLA SICUREZZA	122
AVVERTENZE PER DISPOSITIVI PORTATILI PER ESTERNI	125

FORNITURA	125
INTRODUZIONE	126
CONNETTORI, ELEMENTI DI COMANDO E DI VISUALIZZAZIONE	127
UTILIZZO	129
INSTALLAZIONE E MONTAGGIO	134
MONTAGGIO / SMONTAGGIO DEL LIMITATORE DI BATTENTI E DEL TELAIO DEL FILTRO / PULIZIA DELLE LENTI	135
PULIZIA, MANUTENZIONE E RIPARAZIONE	136
INGOMBRO	138
DATI TECNICI	139
SPIEGAZIONI SULLA PROTEZIONE IP	141
DISTANZA MINIMA DALLA SUPERFICIE ILLUMINATA	141
DISTANZA MINIMA DAI MATERIALI NORMALMENTE INFIAMMABILI	141
SMALTIMENTO	142
DICHIARAZIONI DEL PRODUTTORE	
DMX	
DMX CONTROL / DMX STEUERUNG / PILOTAGE DMX / CONTROL DMX / STEROWANIE DMX / CONTROLLO DMX	144

YOU HAVE MADE THE RIGHT CHOICE!

This device has been developed and manufactured to the highest quality standards to ensure many years of problem-free operation. Please read this user manual carefully to be able to use your new Cameo product quickly and optimally. Further information about Cameo Light is available on our website **CAMEOLIGHT.COM**.

INFORMATION ON THIS USER MANUAL

- Carefully read the safety instructions and the entire manual before operating the device.
- Observe the warnings on the device and in the user manual.
- Always keep the user manual within reach.
- If you sell or pass on the device, it is important that you also include this user manual, as it is an integral part of the product.

INTENDED USE

The product is a device for event technology!

This product has been developed for professional use in the field of event technology and is not suitable for use as domestic lighting!

Furthermore, this product is only intended for qualified users with specialist knowledge of event technology!

Use of the product outside the specified technical data and operating conditions is considered improper use!

Liability for damage and third-party damage to persons and property due to inappropriate use is excluded!

The product is not suitable for:

- Use by persons (including children) with limited physical, sensory or mental abilities or lack of experience and knowledge.
- Children (children must be instructed not to play with the device).

DEFINITIONS AND SYMBOL EXPLANATIONS

1. **DANGER:** The word DANGER, possibly in combination with a symbol, indicates immediately dangerous situations or conditions for life and limb.
2. **WARNING:** The word WARNING, possibly in combination with a symbol, indicates potentially dangerous situations or conditions for life and limb.
3. **CAUTION:** The word CAUTION, possibly in combination with a symbol, is used to indicate situations or conditions that may lead to injury.
4. **ATTENTION:** The word ATTENTION, possibly in combination with a symbol, refers to situations or states that can lead to damage to property and/or the environment.



This symbol identifies hazards that can cause electric shock.



This symbol identifies hazardous areas or hazardous situations.



This symbol indicates hazards caused by hot surfaces.



This symbol indicates hazards caused by intense light sources.



This symbol denotes a device that does not contain any user-serviceable parts.



This symbol indicates additional information on the operation of the product.

SAFETY INSTRUCTIONS



HAZARD:

1. Do not open the device and do not perform any modifications.
2. If your device no longer functions properly, if liquids or objects get inside it or if it has been damaged in any other way, switch it off immediately and disconnect it from the mains. The device may be repaired only by authorised repair technicians.
3. For devices of protection class 1, the protective conductor must be connected correctly. Never disconnect the protective conductor. Devices of protection class 2 do not have a protective conductor.
4. Ensure that live cables are not kinked or otherwise mechanically damaged.
5. Never bypass the device fuse.



WARNING:

1. The device may not be operated if it shows obvious signs of damage.
2. The device may only be installed in a voltage-free state.
3. If the device's power cable is damaged, the device may not be used.
4. Permanently connected power cables may only be replaced by a qualified person.

**ATTENTION:**

1. Do not switch on the device if it has been exposed to extreme temperature fluctuations (for example, following transport). Moisture and condensation can damage the device. Switch on the device only when it has reached room temperature.
2. Ensure that the voltage and frequency of the mains supply match the values specified on the device. If the device has a voltage selector switch, do not connect the device until it has been set correctly. Use only suitable power cables.
3. To disconnect the device from the mains on all poles, it is not sufficient to press the on/off switch on the device.
4. Make sure that the fuse used corresponds to the type printed on the device.
5. Ensure that suitable measures have been taken against overvoltage (e.g. lightning strikes).
6. Observe the specified maximum output current on devices with a Power Out connection. Ensure that the total current consumption of all connected devices does not exceed the specified value.
- 7 Replace plug-in power cables with original cables only.

**HAZARD:**

1. Danger of suffocation! Plastic bags and small parts must be kept out of reach of persons (including children) with reduced physical, sensory or mental capabilities.
2. Danger from falling down! Make sure that the device is securely installed and will not fall down. Only use suitable stands or mounts (particularly for fixed installations). Ensure that accessories are properly installed and secured. Ensure that applicable safety regulations are observed.

**WARNING:**

1. Use the device in the prescribed manner only.
2. Operate the device using only accessories of the type recommended and supplied by the manufacturer.
3. Observe safety regulations applicable in your country during installation.
4. After connecting the device, ensure that all cables are routed so as to avoid damage or accidents, such as from tripping.
5. Always observe the specified minimum distance to normally flammable materials! Unless explicitly stated, the minimum distance is 0.3 m.

**CAUTION:**

1. Moving components such as mounting brackets or other movable components may become jammed.
2. In the case of devices with motor-driven components, there is a risk of injury due to the movement of the device. Sudden device movement can cause shock reactions.
3. The housing surface of the device can become very hot during regular operation. Ensure that accidental touching of the housing is not possible. Always allow the lamp to cool sufficiently before removal, maintenance work and charging etc.

**ATTENTION:**

1. Do not install or use the device in the vicinity of radiators, accumulators, stoves, or other heat sources. Ensure that the device is always installed in such a way that it is sufficiently cooled and cannot overheat.
2. Do not place any ignition sources, such as burning candles, near the device.
3. Ventilation openings must not be covered and fans must not be blocked.
4. For transport, use the original packaging or packaging provided by the manufacturer.
5. Avoid any impacts to or shaking of the device.
6. Observe the IP rating and the ambient conditions such as temperature and humidity according to the specifications.
7. Devices can be continuously further developed. In the event of deviating information on operating conditions, performance or other device properties between the user manual and the device labelling, the information on the device always takes priority.
8. The device is not suitable for tropical climate zones or for operation over 2,000 m above sea level.
9. Unless explicitly stated, the device is not suitable for operation under marine conditions.

**PLEASE NOTE:**

For conversion or retrofit sets or accessories provided by the manufacturer, it is essential to observe the instructions included.

CAUTION! IMPORTANT INFORMATION REGARDING LIGHTING PRODUCTS!

1. Never look directly into the beam of light, not even for a short period of time.
2. Never look into the beam of light using optical devices such as a magnifying glass.



3. Stroboscopic effects may cause epileptic seizures in susceptible individuals!



4. Permanently installed lamps are built into these lighting units. These may not be replaced by the user. The lamps contained in this lighting unit may only be replaced by the manufacturer, its service partner, or a similarly qualified person.

NOTES ON PORTABLE OUTDOOR DEVICES

1. Temporary operation! Event equipment is generally only designed for temporary operation.
2. Continuous operation or permanent structural installation – particularly outdoors – can impair the function, surfaces and seals and accelerate material fatigue.
3. Damage to the surface coating can impair the device's corrosion protection. Damaged surface coating (e.g. scratches) must be promptly repaired by suitable measures.

PACKAGING CONTENT

Remove the product from the packaging and remove all packaging material.

Please check the completeness and integrity of the delivery and notify your distribution partner immediately after purchase if the delivery is not complete or if it is damaged.

Included in the scope of delivery of the product CLF2DIP are:

- ▶ 1 x Cameo F2 D IP Spotlight
- ▶ 1x power cable
- ▶ 1 x sash limiter
- ▶ 1 x filter frame
- ▶ User manual

The scope of delivery of the product CLF2TIP includes:

- ▶ 1 x Cameo F2 T IP Spotlight
- ▶ 1x power cable
- ▶ 1 x sash limiter
- ▶ 1 x filter frame
- ▶ User manual

INTRODUCTION

Daylight profile spotlight

CLF2DIP

Tungsten profile spotlight

CLF2TIP

CONTROL FUNCTIONS:

1-channel, 2-channel 1, 2-channel 2, 3-channel, 4-channel and 5-channel DMX-functions

Master/slave operation

Standalone functions

FEATURES:

IP65 protection class. 16° - 40° beam angle, manual zoom. 200mm Fresnel lens. Adjustable PWM frequency (flicker-free). DMX-512 control. RDM-enabled. Manual control. Quicklight function. 4 dimming curves. 16 bit dimming. Master/Slave operation. Extremely quiet operation due to combined heat pipe and fan cooling. Operating voltage 100–240 V AC/50–60Hz. Power consumption 220 W Mounting bracket, filter frame and 8-position barn doors included.

LIGHTING AGENT CLF2DIP

1 x high-power 240 W daylight LED.

LIGHTING AGENT CLF2TIP

1 x high-power 240 W Tungsten LED (warm white).

Both spotlights feature the RDM standard (remote device management). Remote device management allows the user to view the status and configuration of RDM terminals via an RDM-capable controller.

CONNECTIONS, OPERATING AND DISPLAY ELEMENTS

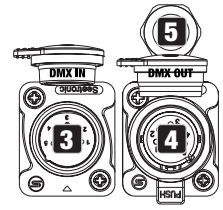
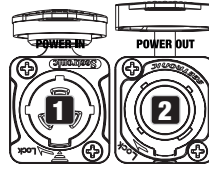
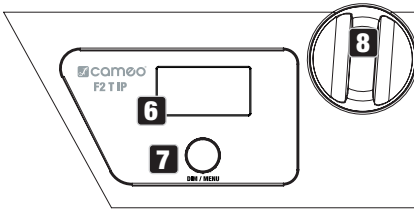

- The CLF2TIP and CLF2DIP models have identical connections, controls and displays -

1 POWER IN

TRUE 1-compatible power input socket. Operating voltage 100–240 V AC/50–60 Hz.

2 POWER OUT

TRUE1-compatible mains output socket for power supply to additional CAMEO spotlights. Ensure that the total power consumption of all devices connected to the device does not exceed the given ampere (A) value.

3 DMX IN

Male 5-pin XLR socket for connection to a DMX control device (e.g. DMX console).

4 DMX OUT

Female 5-pin XLR socket for sending the DMX control signal.

5 PRESSURE EQUALISATION ELEMENT

Pressure equalisation element to prevent condensation inside the housing. In order to ensure its proper function, the element must be protected from contamination.

6 OLED DISPLAY

Displays currently active mode and the menu items in the Edit menu.

7 DIM/MENU

Rotary-push encoder for the adjustment and control of the spotlight.

DIM – If one of the DMX modes is enabled and there is no DMX signal to the device, the encoder serves as master dimmer control and you can set the brightness of the spotlight with values from 000 to 255 by turning the encoder (Quicklight).

Quicklight
000–255

MENU – Push the encoder to access the main menu and select menu items by turning the encoder.

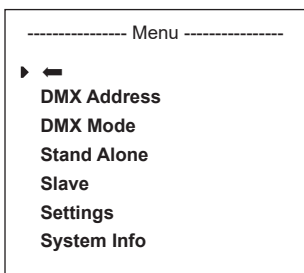

8 ZOOM

On either side of the cabinet is a calibration control to manually adjust the beam angle. The two controls are mechanically linked and are directly opposite each other on the housing. Turn the calibration control to adjust the beam angle of the spotlight continuously from 40° to 15°. A rack and pinion system moves the zoom tube with the Fresnel lens in and out of the housing. The further the zoom tube protrudes from the housing, the smaller the beam angle. A stop mechanism prevents the tube from becoming detached from the housing.



ATTENTION: In order to provide protection from spraying water, in accordance with protection class IP65, special IP65-rated XLR connectors must be used correctly with the DMX input and output sockets, or they must be closed using the rubber sealing caps. When connected correctly, or when sealed correctly with the rubber sealing caps, the POWER IN and POWER OUT sockets are protected from spraying water, as in accordance with IP65.

OPERATION

NOTES

- As soon as the spotlight is correctly connected to the power supply, the following will be displayed in succession: “Welcome to Cameo”, the model name and the software version. After this process, the lamp is ready for operation and starts in the previously enabled mode.
- If one of the DMX modes or slave mode is enabled and there is no control signal at the DMX input, the characters in the display will start to flash.
- If no input is made within approximately 30 seconds, the currently activated mode is automatically shown in the display (main display).

MAIN DISPLAY

The main display shows the currently activated mode (in the example DMX mode with DMX start address 001).

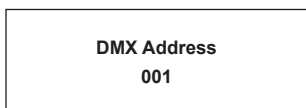

SET DMX START ADDRESS (DMX Address)

Press the encoder to access the main menu. Rotate the encoder to select the menu item **DMX Address** (left arrow) and confirm by pushing the encoder. You can now configure the DMX start address as required by rotating the encoder (the highest value depends on the selected DMX mode). Confirm the entry by pushing the encoder. Select the arrow symbol at the top of the menu for **back** and push the encoder to return to the main display. The main display is activated automatically if no input is made within approximately 30 seconds. DMX mode is automatically activated when setting the DMX start address.

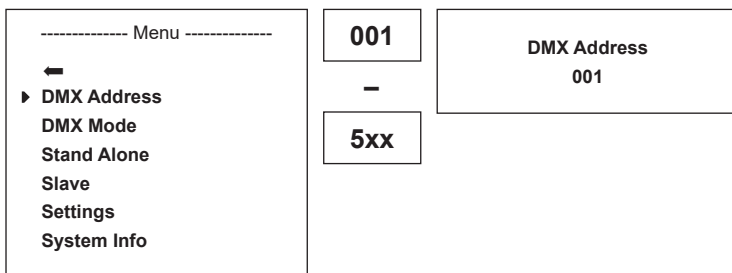

CONFIGURING DMX MODE (DMX Mode)

Press the encoder to access the main menu. Rotate the encoder to select the menu item **DMX Mode** (left arrow) and confirm by pushing the encoder. You can now select the desired DMX mode by rotating the encoder (5CH, 4CH, 3CH, 2CH 2, 2CH 1, 1CH). Confirm the selection by pushing the encoder. Select the arrow symbol at the top of the menu for **back** and push the encoder to return to the main display. The main display is activated automatically if no input is made within approximately 30 seconds. Tables with the channel assignment of the different DMX modes can be found in these instructions under DMX CONTROL.

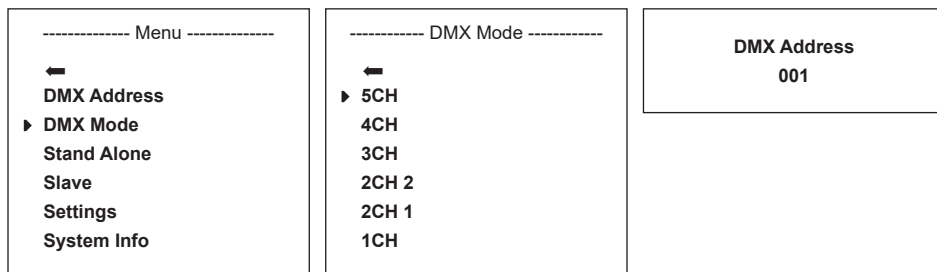

STATIC MODE

Press the encoder to access the main menu. Rotate the encoder to select the menu item **Stand Alone** (left arrow) and confirm by pushing the encoder. Now select the submenu item **Dimmer** and confirm by pushing the encoder and rotate the encoder to set the desired brightness with values between 000 (blackout) and 255 (maximum brightness). Confirm your entry by pressing the encoder. A stroboscopic effect can now be activated as required and set in the same way (strobe value 000 = strobe off. Value 001 = lowest flash frequency. Value 255 = highest flash frequency). Now select the arrow symbol for **back** at the top of the submenu. Push the encoder and access the main menu in the same way to return to the main display.

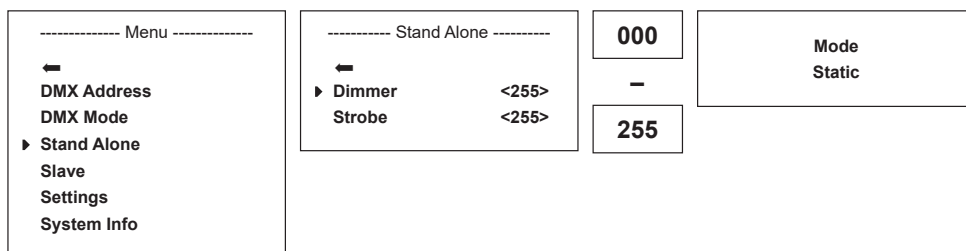

SLAVE MODE

Press the encoder to access the main menu. Rotate the encoder to select the menu item **Slave** (left arrow) and confirm by pushing the encoder. Slave mode is now enabled, and the main display is automatically displayed. Connect the slave and the master units (same model) with a DMX cable and enable the standalone mode static on the master unit. The slave unit will now follow the master unit.

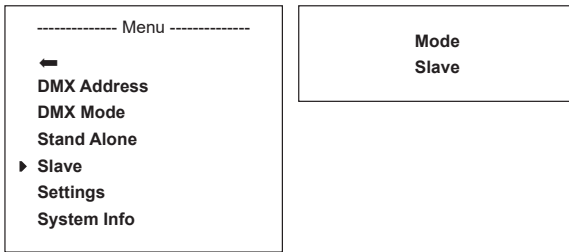

DEVICE SETTINGS (Settings)

Press the encoder to access the main menu. Rotate the encoder to select the menu item **Settings** (left arrow) and confirm by pushing the encoder. This will take you to the submenu for setting the submenu items (see table, rotate the encoder to select and push the encoder to confirm selection). Now select the arrow symbol for **back** at the top of the submenu. Push the encoder and access the main menu in the same way to return to the main display. The main display is activated automatically if no input is made within approximately 30 seconds.

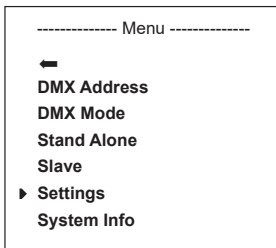

Settings			
Display Reverse	=	Rotate display	← Back
			On Display is rotated by 180° (e.g. for overhead installation)
			Off No display rotation
Display Off	=	Display lighting	← Back
			On On permanently
			Off Deactivation after approximately 1 minute of inactivity

DMX fail	=	Operational status with DMX signal fault	←	Back
			Hold	Last command is retained
			or blackout,	Activates blackout
			Full On	Spotlight switches to full on
			Standalone	Stand alone mode is activated
Dimmer curve	=	Dimmer curve	←	Back
			Linear	Light intensity increases linearly with DMX value
			Exponential	Light intensity can be finely adjusted at lower DMX values and broadly adjusted at higher DMX values
			Logarithmic	Light intensity can be broadly adjusted at lower DMX values and finely adjusted at higher DMX values
			S-curve	Light intensity can be finely adjusted at lower and higher DMX values and broadly adjusted at medium DMX values
Dimmer response	=	Dimmer response	←	Back
			LED	Light responds abruptly to changes in DMX value
			Halogen	Light behaves like a halogen spotlight with slight brightness changes
LED Frequency	=	LED PWM frequency	←	Back
			800 Hz / 1200 Hz / 2000 Hz / 3600 Hz / 12 kHz / 25 kHz	Configuration of LED PWM frequency
Fan	=	Adjust fan control	←	Back
			Car	Automatic fan speed control
			Off	Deactivated fan with greatly reduced brightness
			Constant Low	Constantly low fan speed with reduced brightness, if necessary
			Constant Medium	Constant average fan speed with reduced brightness, if necessary
			Constant High	Constant high fan speed
Factory Reset	=	Reset to factory setting	←	Back
			Reset Now!	Reset to factory settings

DIMMER CURVES

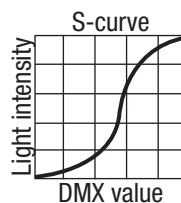
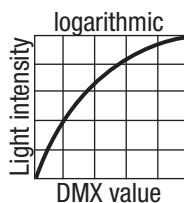
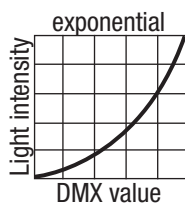
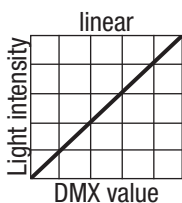

SYSTEM INFORMATION (System Info)

Press the encoder to access the main menu. Rotate the encoder to select the menu item **System info** (left arrow) and confirm by pushing the encoder. This will take you to the submenu for selecting the submenu items (see table, rotate the encoder to select and push the encoder to confirm selection). Now select the arrow symbol for **back** at the top of the submenu. Push the encoder and access the main menu in the same way to return to the main display. The main display is activated automatically if no input is made within approximately 30 seconds.

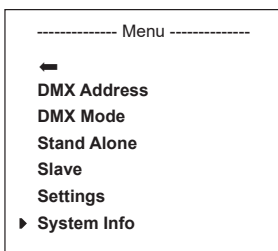

System Info				
Firmware	=	Displays device firmware	Main CPU	Vx.xx
Temperature	=	Displays temperature of LED unit	←	Back
			LED	xx °C / xx °F
			Unit	°C (= display in degrees Celsius) °F (= display in degrees Fahrenheit)
Operation Hours	=	Displays operating time	xx:xx h	Displays total operating time in hours and minutes

SETUP AND INSTALLATION



DANGER: Overhead mounting requires extensive experience, including the calculation of the load limit values of the installation material and regular safety inspection of all installation materials and spotlights. If you do not have these qualifications, do not attempt to perform an installation yourself. Refer instead to a qualified professional. There is a risk that devices that are incorrectly mounted and secured may come loose and fall down. This can cause serious injury or death.

Thanks to its four plastic feet, the spotlight can be positioned in a suitable location on a level surface. Mounting to a traverse is possible with the pre-installed mounting bracket (A) and a suitable traverse clamp (optional). Ensure firm connections and secure the spotlight by attaching a suitable safety cable to the point intended for this purpose on top of the housing (B). Use the lever screw (C) on one side to adjust the direction of radiation on a vertical plane.



ASSEMBLE / DISASSEMBLE SASH LIMITER AND FILTER FRAME / CLEAN LENSES

Fully disconnect the device from the mains. To install or remove the barn doors and the filter frame please push the spring-loaded locking pin (D) of the bracket so that it folds upwards. Then return the bracket to its original position so that the locking pin re-engages. The support arm for the sash limiter and filter frame on the underside of the spotlight has a second safety device (E) so that an additional safety rope for the sash limiter is not required. When the sash limiter is mounted on the headlamp, move the lever (E) on the lower retaining arm to the position parallel to the headlamp so that the latch (F) effectively prevents the sash limiter from sliding out of the retaining arm. To open the safety device, turn the lever 90°. To secure the filter frame, use the safety rope supplied.



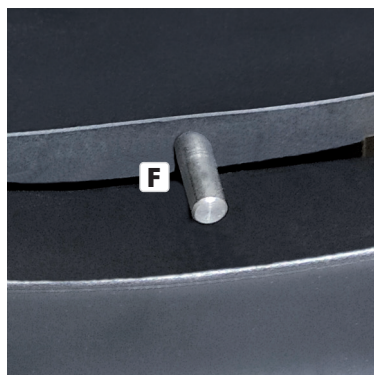

The front lens (G) is in a rubber frame and the glass lens (H) is located behind it. These can be cleaned by folding the bracket upwards (as previously described) and lifting the front lens (with the rubber frame) out of the angle brackets. Clean the front lens and the glass lens located behind it with a moist, lint-free cloth, making sure not to scratch the surface of the lenses. Now place the front lens in front of the glass lens (H) and fold the bracket back downward until the locking pin engages.



- Illustrations similar -



CAUTION: For safety reasons, the filter frame must always be in the respective bracket on the spotlight, even if no filter is inserted!

CARE, MAINTENANCE AND REPAIR

In order to ensure the long-term, proper functioning of the device, it must be regularly cleaned and, if necessary, maintained. The maintenance requirement depends on the intensity of use and the environment in which it is used.

We generally recommend a visual inspection before each operation. Furthermore, we recommend carrying out all the applicable maintenance measures specified below once every 500 operating hours or, in the case of a lower intensity of use, at the latest after one year. Warranty claims may be limited in the event of defects resulting from inadequate maintenance.

CARE (carried out by user)



WARNING! Before carrying out any care or maintenance, the power supply – and, if possible, all device connections – must be disconnected.



PLEASE NOTE! Improper care can lead to impairment of the device or even its destruction.

1. Housing surfaces must be cleaned with a clean, damp cloth. Make sure that no moisture can penetrate the device.
2. Air inlets and outlets must be regularly cleaned of dust and dirt. If compressed air is used, make sure that damage to the device is prevented (e.g. fans must be blocked in this case).
3. Lines and plug contacts must be cleaned regularly and dust and dirt must be removed.
4. In general, no cleaning agents or abrasive agents may be used, otherwise the surface finish may be damaged.
5. Devices must generally be stored dry and protected from dust and dirt.

MAINTENANCE AND REPAIR (by qualified personnel only)



HAZARD! There are live components in the device. Even after disconnecting the mains connection, there may still be residual voltage in the device, for example, due to charged capacitors.



PLEASE NOTE! There are no user-serviceable components in the device.



PLEASE NOTE! Maintenance and repair work may only be carried out by qualified specialist personnel authorised by the manufacturer. If in doubt, consult the manufacturer.



PLEASE NOTE! Improperly performed maintenance work may affect warranty claims.

DIMENSIONS

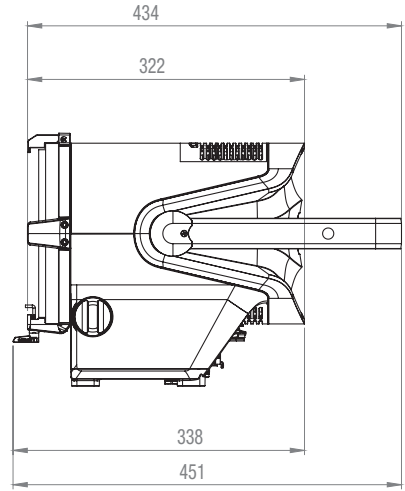
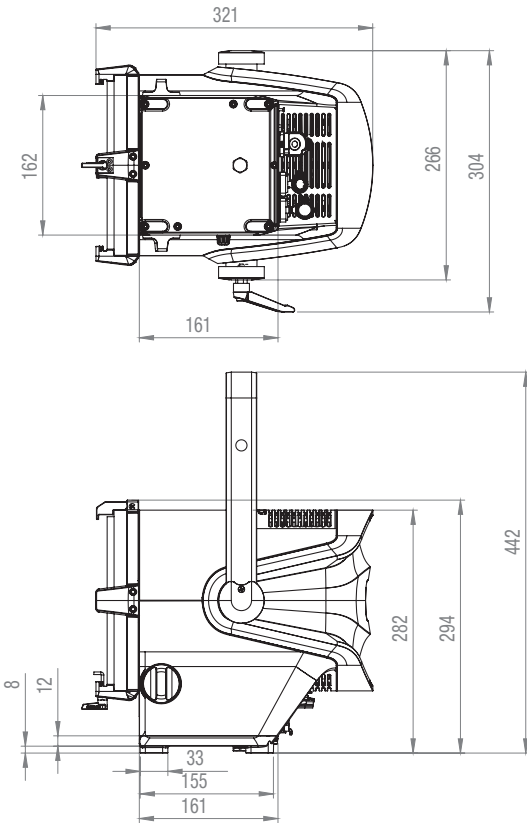

TECHNICAL DATA

PRODUCT NUMBER:	CLF2TIP	CLF2DIP
Product type:	LED spotlight	LED spotlight
Type:	Fresnel spotlight with zoom function	Fresnel spotlight with zoom function
Colour spectrum:	Tungsten (warm white) 3200 K	Daylight 5400 K
CRI:	97	96
Number of LEDs:	1	1
LED type:	240 W	240 W
LED PWM frequency:	800 Hz, 1200 Hz, 2000 Hz, 3600 Hz, 12 kHz, 25 kHz (adjustable)	800 Hz, 1200 Hz, 2000 Hz, 3600 Hz, 12 kHz, 25 kHz (adjustable)
Beam angle:	16° - 40° (field 28° to 60°)	16° - 40° (field 28° to 60°)
DMX input:	5-pin XLR male, IP65	5-pin XLR male, IP65
DMX output:	5-pin female XLR, IP65	5-pin female XLR, IP65
DMX mode:	1-channel, 2-channel 1, 2-channel 2, 3-channel, 4-channel, 5-channel	1-channel, 2-channel 1, 2-channel 2, 3-channel, 4-channel, 5-channel
DMX functions:	Dimmer, dimmer fine, strobe, dimmer curve, dimmer response, PWM frequency, fan setting	Dimmer, dimmer fine, strobe, dimmer curve, dimmer response, PWM frequency, fan setting
Control:	DMX512, RDM-enabled	DMX512, RDM-enabled
Standalone functions:	Dimmer, strobe, master/slave	Dimmer, strobe, master/slave
Operating controls:	DIM/MENU rotary-push encoder, manual zoom	DIM/MENU rotary-push encoder, manual zoom
Display elements:	OLED display	OLED display
Operating voltage:	100–240 V AC/50–60 Hz	100–240 V AC/50–60 Hz
Power consumption:	220 W	220 W
Luminous flux:	14,000 lm	15,000 lm
Power supply connection:	INPUT: TRUE1 compatible OUTPUT: TRUE1 compatible (max. 6 A)	INPUT: TRUE1 compatible OUTPUT: TRUE1 compatible (max. 6 A)
Ambient temperature (in operation):	0°C to 40°C	0°C to 40°C
Protection class:	IP65	IP65
Housing material:	Die-cast metal	Die-cast metal
Housing colour:	Black	Black

ENGLISH

DEUTSCH

FRANÇAIS

ESPAÑOL

POLSKI

ITALIANO

DMX

ENGLISH

Housing cooling:	Temperature-controlled fan + heat pipe	Temperature-controlled fan + heat pipe
------------------	--	--

Minimum distance to illuminated surface	0.5 m	0.5 m
---	-------	-------

Minimum distance to normally flammable materials	0.5 m	0.5 m
--	-------	-------

Dimensions (W x H x D, without sash limiter):	304 x 294 x 434 mm (for details see drawings)	304 x 294 x 434 mm (for details see drawings)
---	--	--

Weight:	9.5 kg	9.5 kg
---------	--------	--------

Additional features:	200 mm Fresnel lens, power cable, filter frame, 8-position barn doors and mounting bracket supplied, manual zoom	200 mm Fresnel lens, power cable, filter frame, 8-position barn doors and mounting bracket supplied, manual zoom
----------------------	--	--

DEUTSCH

FRANCAIS

ESPAÑOL

POLSKI

ITALIANO

DMX

EXPLANATION OF IP PROTECTION CLASS

1. An IP rating only reflects protection from solid objects and water. It does not describe general weather resistance, such as protection from UV radiation and temperature, etc.

2. The first identification digit indicates protection from dust, solid objects and contact:

IP2X	Protected against solid foreign bodies ≥ 12.5 mm in diameter
IP3X	Protected against solid foreign bodies ≥ 2.5 mm in diameter
IP4X	Protected against solid foreign bodies ≥ 1.0 mm in diameter
IP5X	Protected against dust in harmful quantities and completely protected against contact
IP6X	Are dust-tight and completely protected against contact

3. The second identification digit indicates protection from water:

IPX0	No protection
IPX1	Protection against dripping water
IPX2	Protection against dripping water when the device is tilted up to 15°
IPX3	Protection against falling spray water up to 60° from the vertical
IPX4	Protection against splashing water on all sides
IPX5	Protection against water jets (nozzle) from any angle
IPX6	Protection against strong water jets
IPX7	Protection against temporary immersion

4. In addition, some device-specific measures such as covers and sealing caps are necessary in order to achieve the specified protection class (e.g. protective caps on unused connections).



The IP rating of the product can be found in the technical data and is printed on the device.

MINIMUM DISTANCE TO ILLUMINATED SURFACE

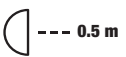
 This symbol with distance specification in metres (m) indicates the minimum distance between the light head and the illuminated surface. In this example, the distance is 0.5 m. Please refer to the technical data in this manual and the imprint on the unit casing for the value valid for this unit!

MINIMUM DISTANCE TO NORMALLY FLAMMABLE MATERIALS

 This symbol with distance specification in metres (m) indicates the minimum distance between the light head and normally flammable materials. In this example, the distance is 0.5 m. Please refer to the technical data in this manual for the value valid for this unit!

DISPOSAL



Packaging:

1. Packaging can be fed into the reusable material cycle using the usual disposal methods.
2. Please separate the packaging in accordance with the disposal laws and recycling regulations in your country.



Device:

1. This device is subject to the European Directive on Waste Electrical and Electronic Equipment, as amended. WEEE Directive Waste Electrical and Electronic Equipment. Old appliances do not belong in household waste. The old device must be disposed of via an approved disposal company or a municipal disposal facility. Please observe the applicable regulations in your country!
2. Observe all disposal laws applicable in your country.
3. As a private customer, you can obtain information on environmentally-friendly disposal options from the seller of the product or the appropriate regional authorities.

MANUFACTURER'S DECLARATIONS

MANUFACTURER'S WARRANTY & LIMITATION OF LIABILITY

Adam Hall GmbH, Adam-Hall-Str. 1, 61267 Neu Anspach, Germany / E-mail Info@adamhall.com / +49 (0)6081 / 9419-0.

Our current warranty conditions and limitation of liability can be found at:

https://cdn-shop.adamhall.com/media/pdf/Manufacturers-Declarations-CAMEO_DE_EN_ES_FR.pdf

Contact your distribution partner for service.

FCC STATEMENT

This device complies with Part 15 of the FCC Rules. Operation is subject to the following two conditions:

- (1) This device may not cause harmful interference, and
- (2) This device must accept any interference received, including interference that may cause undesired operation.

CE CONFORMITY

Adam Hall GmbH hereby confirm that this product meets the following guidelines (where applicable):

Low-Voltage Directive (2014/35/EU)

EMC Directive (2014/30/EU)

RoHS (2011/65/EU)

RED (2014/53/EU)

EC DECLARATION OF CONFORMITY

Declarations of conformity for products subject to the LVD, EMC, RoHS Directive can be requested from info@adamhall.com.

Declarations of conformity for products subject to RED can be downloaded from www.adamhall.com/compliance/.

SUBJECT TO MISPRINTS AND ERRORS, AS WELL AS TECHNICAL OR OTHER MODIFICATIONS!

Adam Hall GmbH

Adam-Hall-Str. 1 | 61267 Neu-Anspach | Germany

Phone: +49 6081 9419-0 | adamhall.com

Adam Hall Ltd. | The Seedbed Business Centre | SS3 9QY Essex | United Kingdom

